

Gleittür / Zubehör S1200 schwebender Griff Einbauanleitung

Sliding door / Accessory S1200 floating handle Installation Instruction

Version 1.0 (05-03-2020)

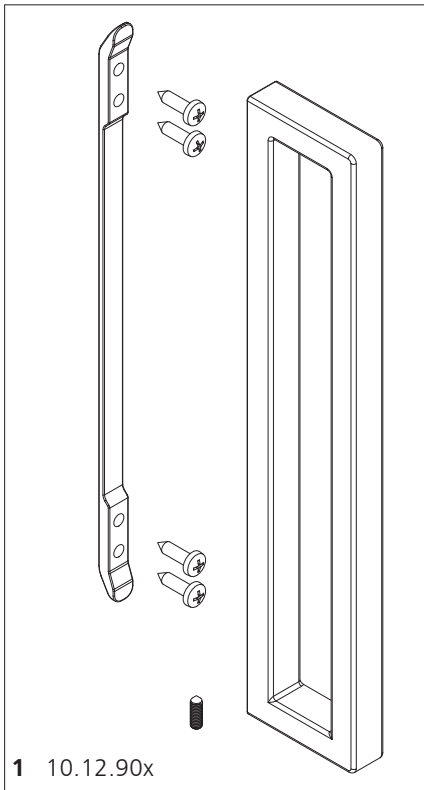

- 1 schwebender Griff S1200
- 2 Bohrschablone, schwebender Griff S1200
- 3 Senkrechtprofil S 1200

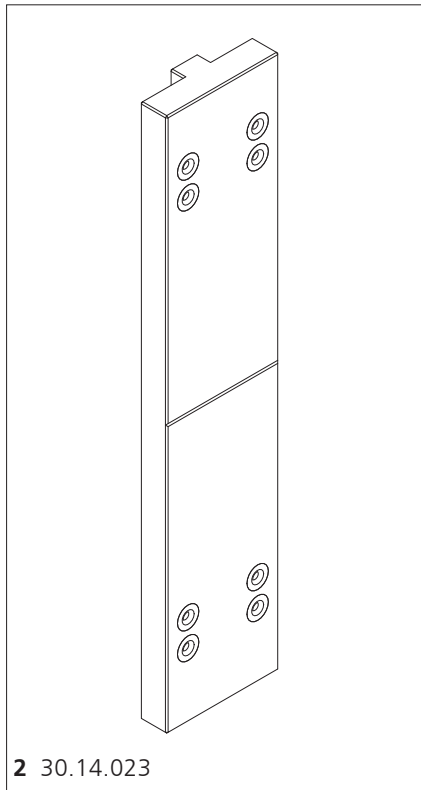

- 1 floating handle S 1200
- 2 drilling template floating handle S 1200
- 3 stile S 1200

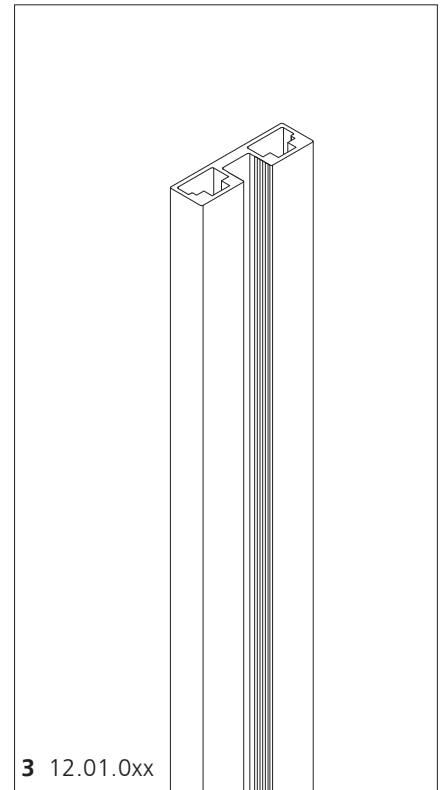

Symbole

- ➔ Richtungsangaben / Bewegung
- ①②③ Reihenfolge beachten

Montagewerkzeug

(ohne Anspruch auf Vollständigkeit)

- | | |
|-----------------------|---------------------|
| Schraubendrehersatz | Bohrer-Set (Metall) |
| Inbusschlüssel 1,5 mm | Bohrmaschine |
| Bleistift | Bandmaß |

System Informationen

- nur für S 1200 (nicht S 1200 LED) Gleittür

Symbols

- ➔ Directional data / movement
- ①②③ Follow the order

Tools

(without claim of completeness)

- | | |
|----------------------|-------------------|
| Screwdriver set | Drill set (metal) |
| Allen key set 1,5 mm | Drilling machine |
| Pencil | Measure tape |

System informations

- only S 1200 (not S 1200 LED) sliding door

Technische Änderungen vorbehalten

Subject to technical changes.



Version
Produktstart 1.0 product launch

Einbauanleitung

nur für S 1200 Gleittür

Installation Instruction

only S 1200 sliding door

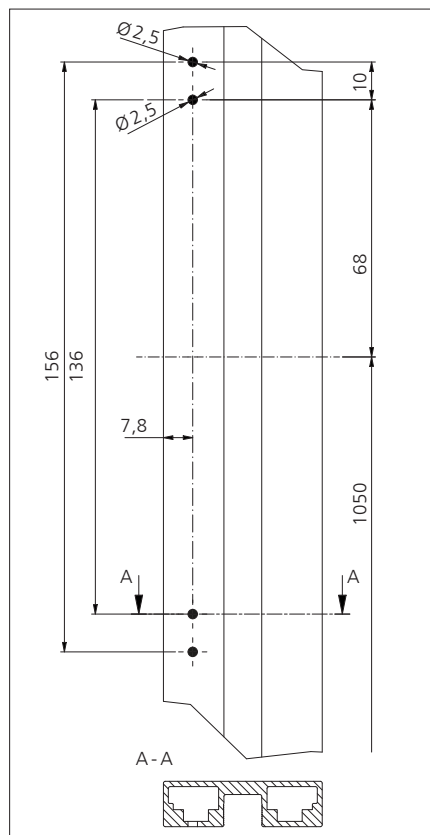

1

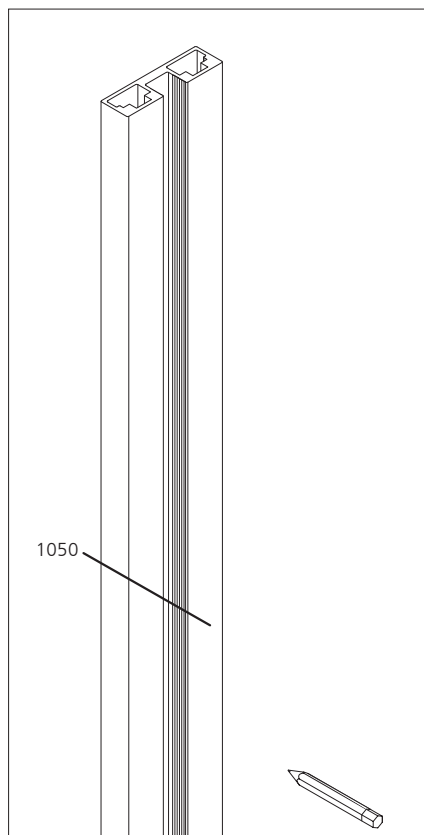

2

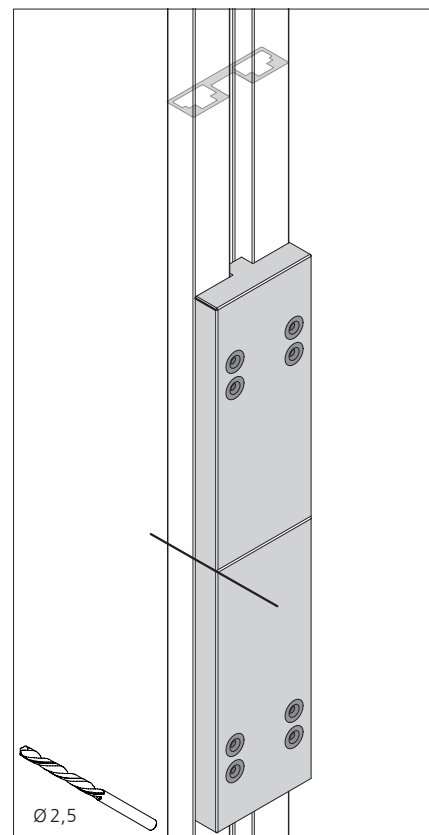

3

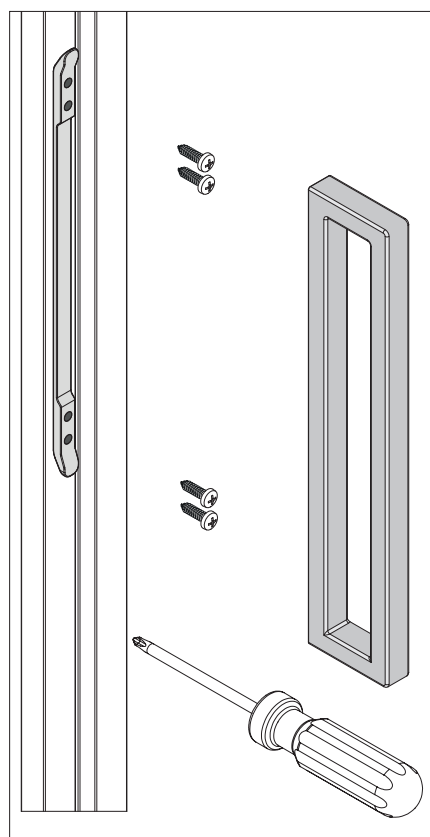

4

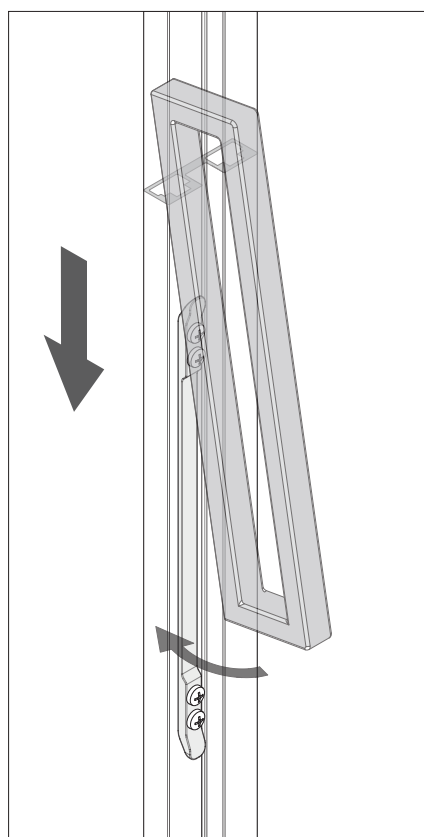

5

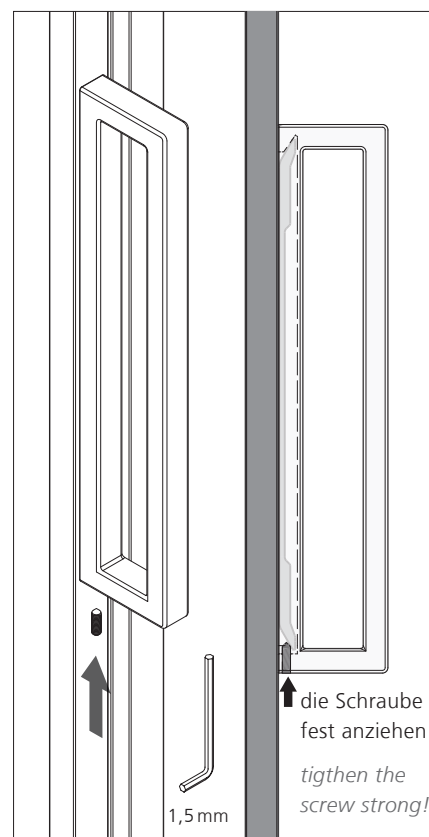

6