

HINGE DOOR: ASSEMBLY INSTRUCTION

SERIES 1200

Version 1.0 (2016-11-30)

2.03.1.c

Assembly  easy medium difficult

Subject to technical changes.

raumplus

CONTENT AND TOOLS

CONTENT:

Content and tools	page	02
Product information	page	03
Accessories	page	05
Exploded drawing	page	06
Cutting dimensions	page	07
Detail drawings	page	08
Assembly instructions	page	10



The working steps described in this instruction are exclusively valid for the hinge door »DIN left«. The assembly for the hinge door »DIN right« is to be carried out mirror-inverted – with special attention to page 11.

TOOLS:

(without claim of completeness)

- Aluminium saw
- Pencil
- Drill set metal
- Drilling machine
- Cutter or blade / wire cutting pliers
- Rubber mallet
- Allen key set



Version 1.0:











VERSION INFORMATION:

PRODUCT INFORMATION

GENERAL INFORMATION: Preparation

- This manual is part of the product and describes the safe and proper installation of the system. Please read the instructions carefully before installation
- Please note that the assembly should only be done by qualified and trained staff in strict compliance with all details indicated in this document. Improper installation in variation from manufacturer's specification may cause defects and danger, thus endangering the safe fixing of the product as well as the safety of the prospective user. The liability of the manufacturer shall be excluded in case of defects and consequential damages resulting from incorrect assembly of this product.
- Please check the completeness of the delivered parts and check carefully if any transport damages are visible.
- If any parts are damaged or lost, please immediately contact the responsible supplier.
- It is assumed that you have exactly identified all cutting dimensions according to the measurement instruction for **raumplus** products.

SYMBOLE:

Symbol	Importance	Symbol	Importance
	Risk or danger!		During the installation do not use a striking tool
	Advice and information		No leverage tool for disassembly of fittings
	Additional information / other documents		Be aware of the risk of entrapment.
	Directional data / direction of movement		do not enter!
	„yes“ and „right“		
	„no“ and „wrong“		
	Follow the order		

SYSTEM:

System Information: S1200

- max. weight of element = **30 kg**
- min./max. door height = **700 mm / 2600 mm**
- min./max. door width = **500 mm / 600 mm**

PRODUCT INFORMATION

GENERAL INFORMATION: **Product safety**

- The System complies with the prior of the art and the authorized safety rules at the time of delivery.

USE:

Intended use

- The prerequisite for the intended use of our products is the professional installation according to our installation instruction. Sufficient fittings must be available and durably installed to all relevant places. The function of the fittings must not be hindered or altered during installation.
- Special solutions are only possible in consultation with **raumplus**.

Incorrect use

- Risk or danger may occur in the following cases:
 - the door system has improperly been installed or maintained
 - the safety and installation instructions have not been followed.
 - after improper installation or inadequate fixing (e.g. to parts of buildings)
 - the maximum weight of the doors has been exceeded.
 - improper shock and case loads or other additional loads on the fittings have occurred
 - the fittings have been used outside.
 - body parts or objects got into the closing edges or door runnings during use of the door wing.
 - the door system is not used as intended.

Structural modifications

- Structural modifications that are not offered as an accessory from **raumplus** may only be attached or installed with permission of **raumplus GmbH!**

ACCESSORIES

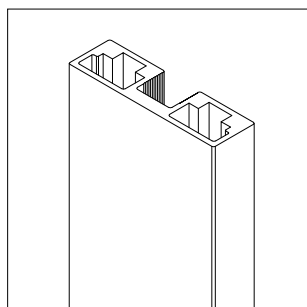

1_ 12.01.0xx

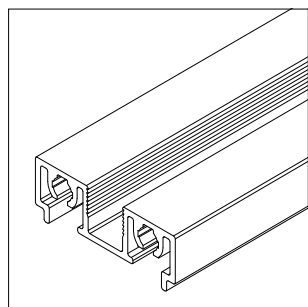

2_ 12.46.0xx

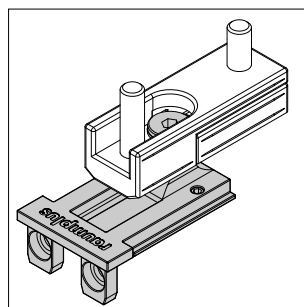

3_ 10.02.420

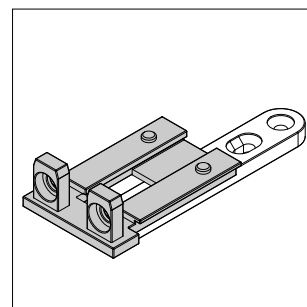

4_ 10.02.450

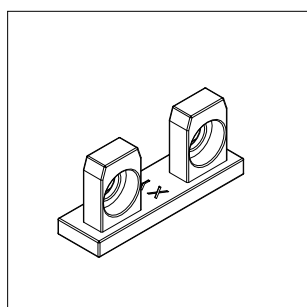

5_ 10.02.460

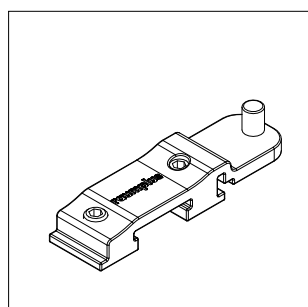

6_ 10.02.510

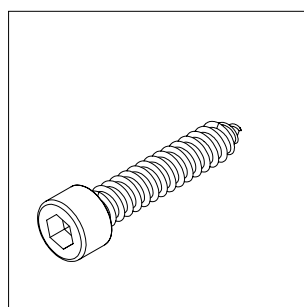

7_ 10.07.012

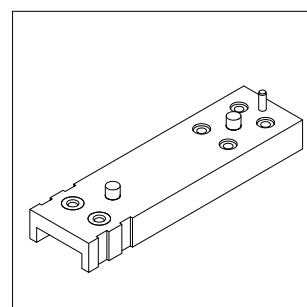

8_ 30.14.018

1_ Stile S1200

2_ Rail folding-/hinge door S1200

3_ Pick up element set for folding-/hinge door S1200

4_ Mounting plate set for folding-/hinge door S1200

5_ Frame connector for folding-/hinge door S1200

6_ Pin for positioning hinge door S1200

7_ Frame screws 6,3 x 32mm stainless steel

white head

10.07.212

black oxidized

10.07.213

silver mat

10.07.214

8_ Drilling template for S1200

without illustration:

10_ Countersink set w. guiding pin S1200

30.14.020

11_ Panel

EXPLODED DRAWING

DIN LEFT

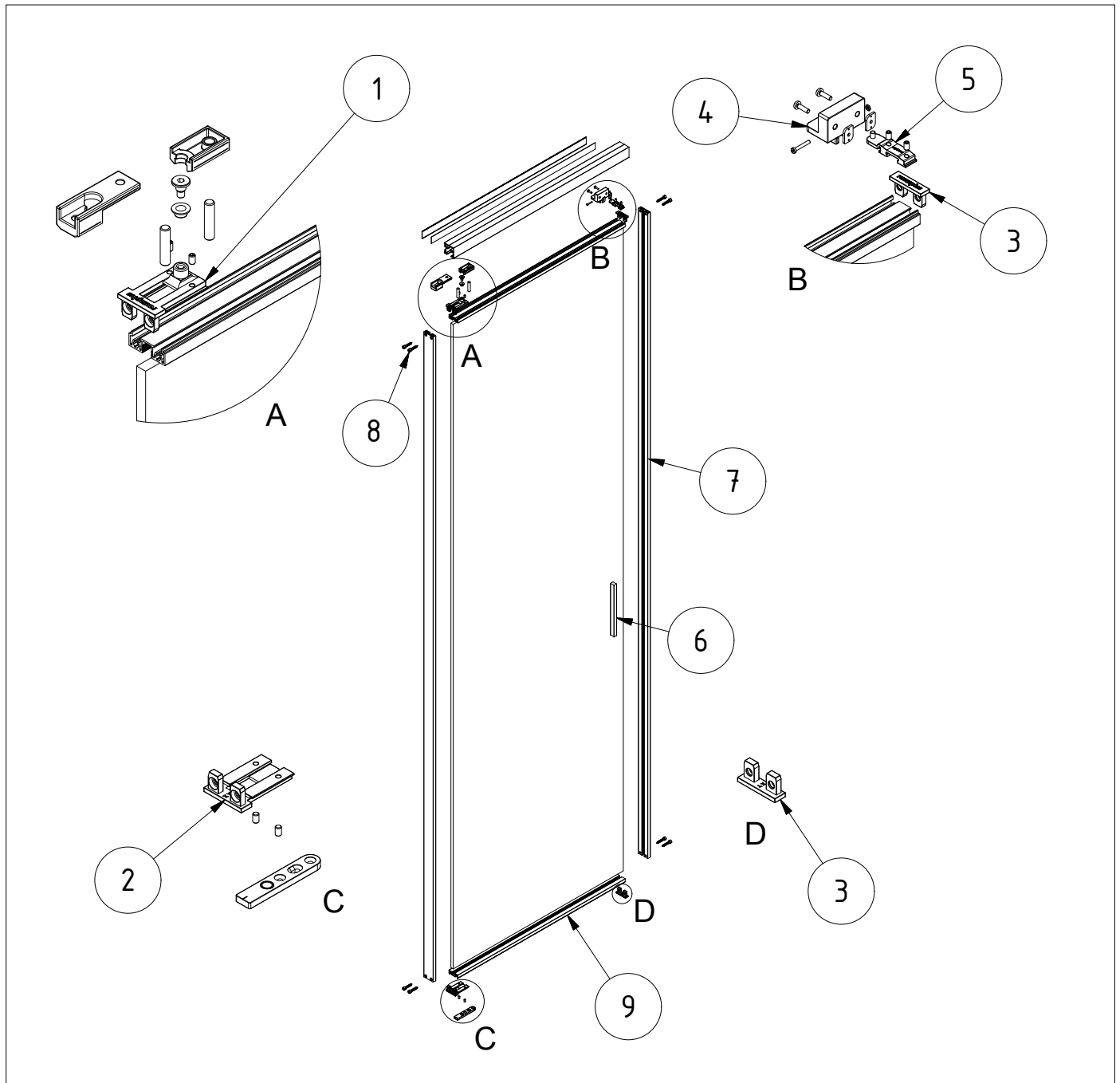

Item list			
Object	Quantity	Item	Item no.
1	1	Pick up element set for folding-/hinge door S1200	10.02.420
2	1	Mounting plate set for folding-/hinge door S1200	10.02.450
3	1	Frame connector for folding-/hinge door S1200	10.02.460
4	1	Top positioning for folding-/hinge door S1200	10.02.470
5	1	Pin for positioning hinge door S1200	10.02.510
6	1	Cuboid handle for hinge door	10.01.93x
7	2	Stile S1200	12.01.0xx
8	8	Frame screws 6,3 x 32mm	10.07.21x
9	2	Rail folding-/hinge door S1200	12.46.0xx

1_ Complete hinge door DIN Left

DETAIL DRAWING

PREPARING STILES / CUTTING DIMENSIONS

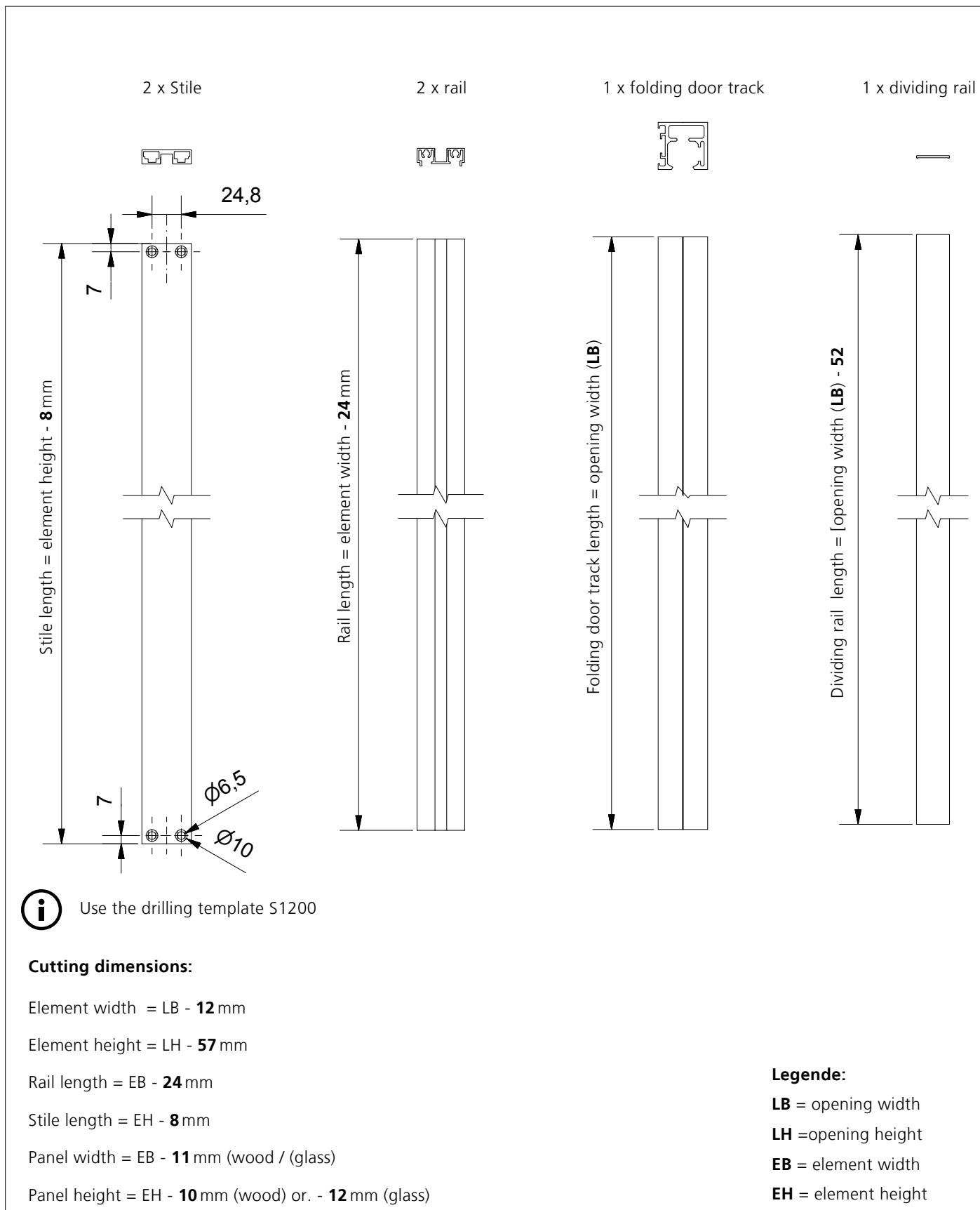

DETAIL DRAWING

HINGE DOOR S800 SINGLE / DOUBLE WING

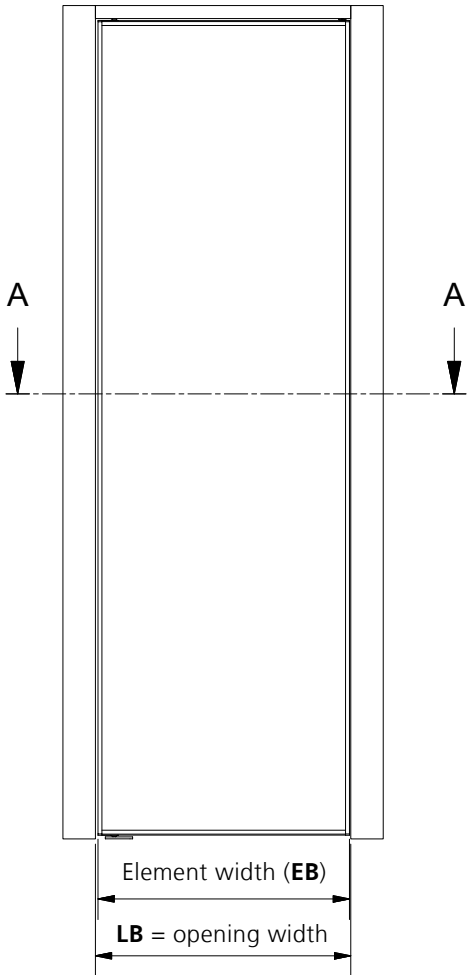

$$\text{Element width} = (\mathbf{LB} - 12)$$

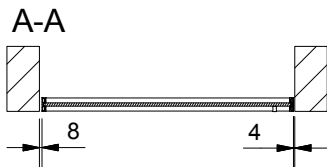

Single wing hinge door

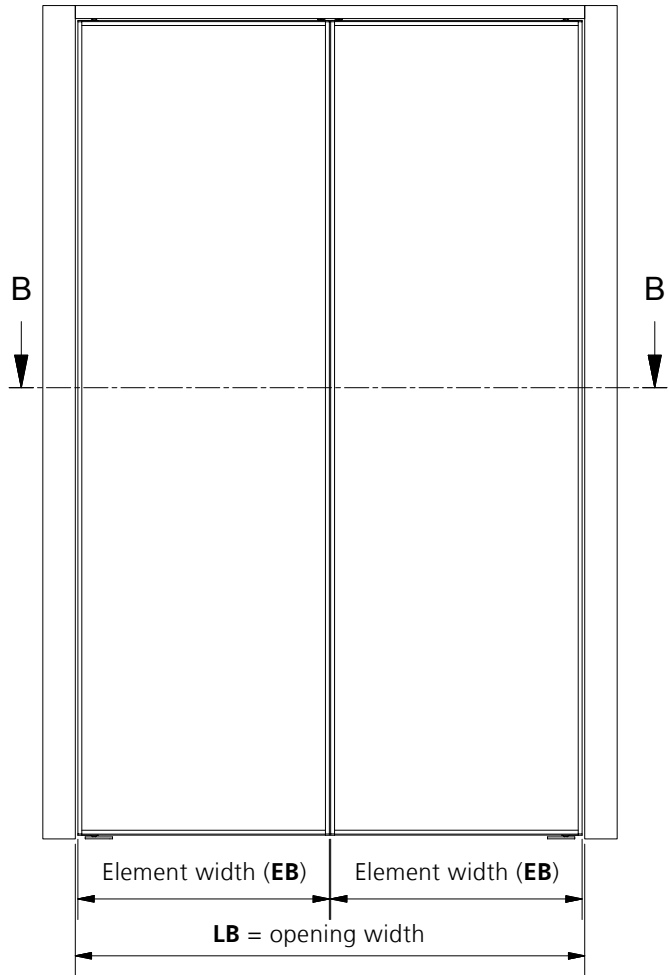

$$\text{Elementbreite (EB)} = (\mathbf{LB} - 20) / 2$$

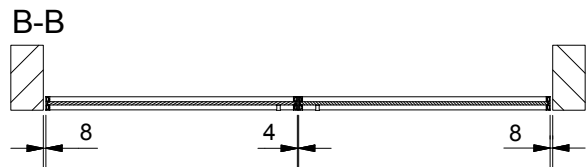

Double wing hinge door

DETAIL DRAWING

EXPLODED DRAWING

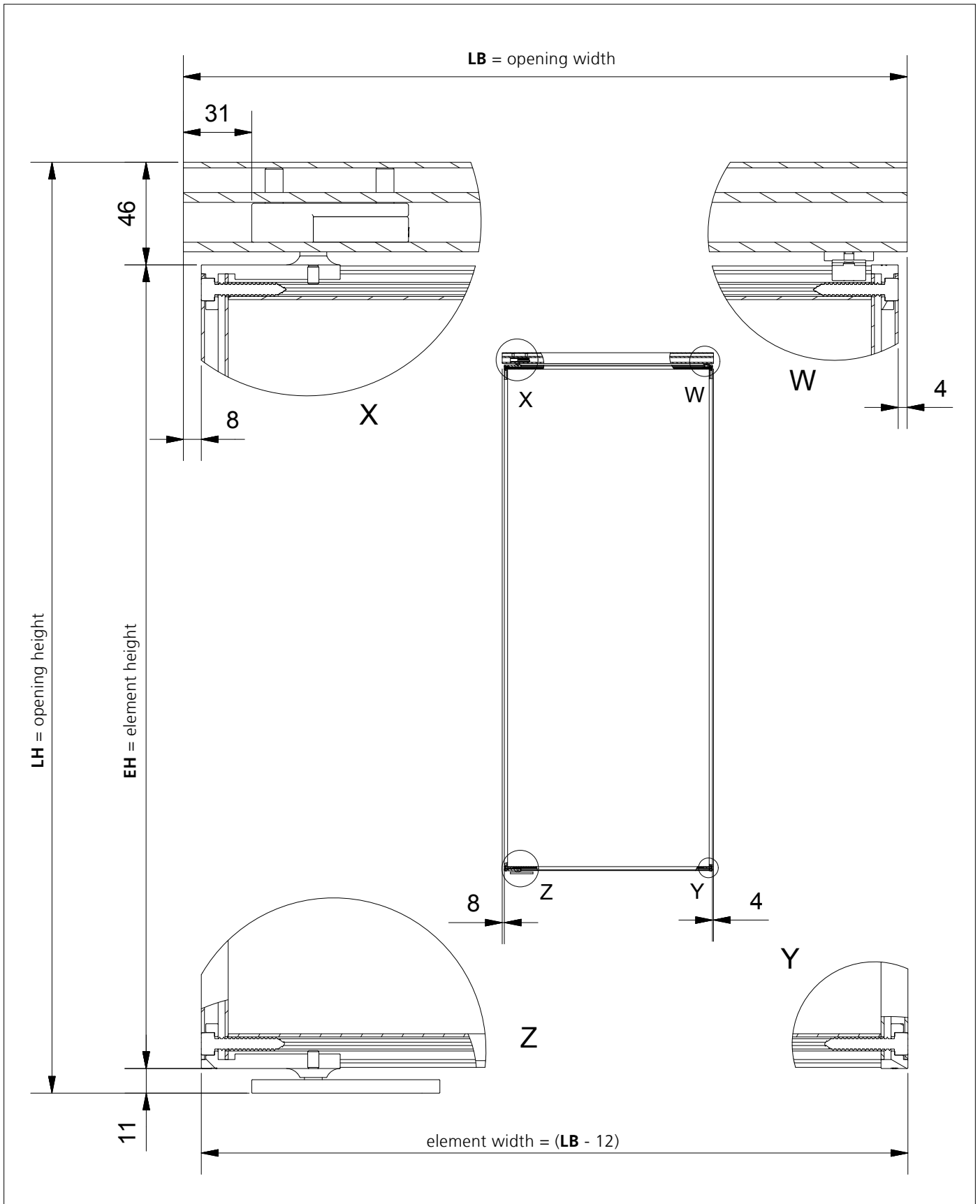

3_

ASSEMBLY INSTRUCTIONS

HINGE DOOR SET S1200 DIN LEFT

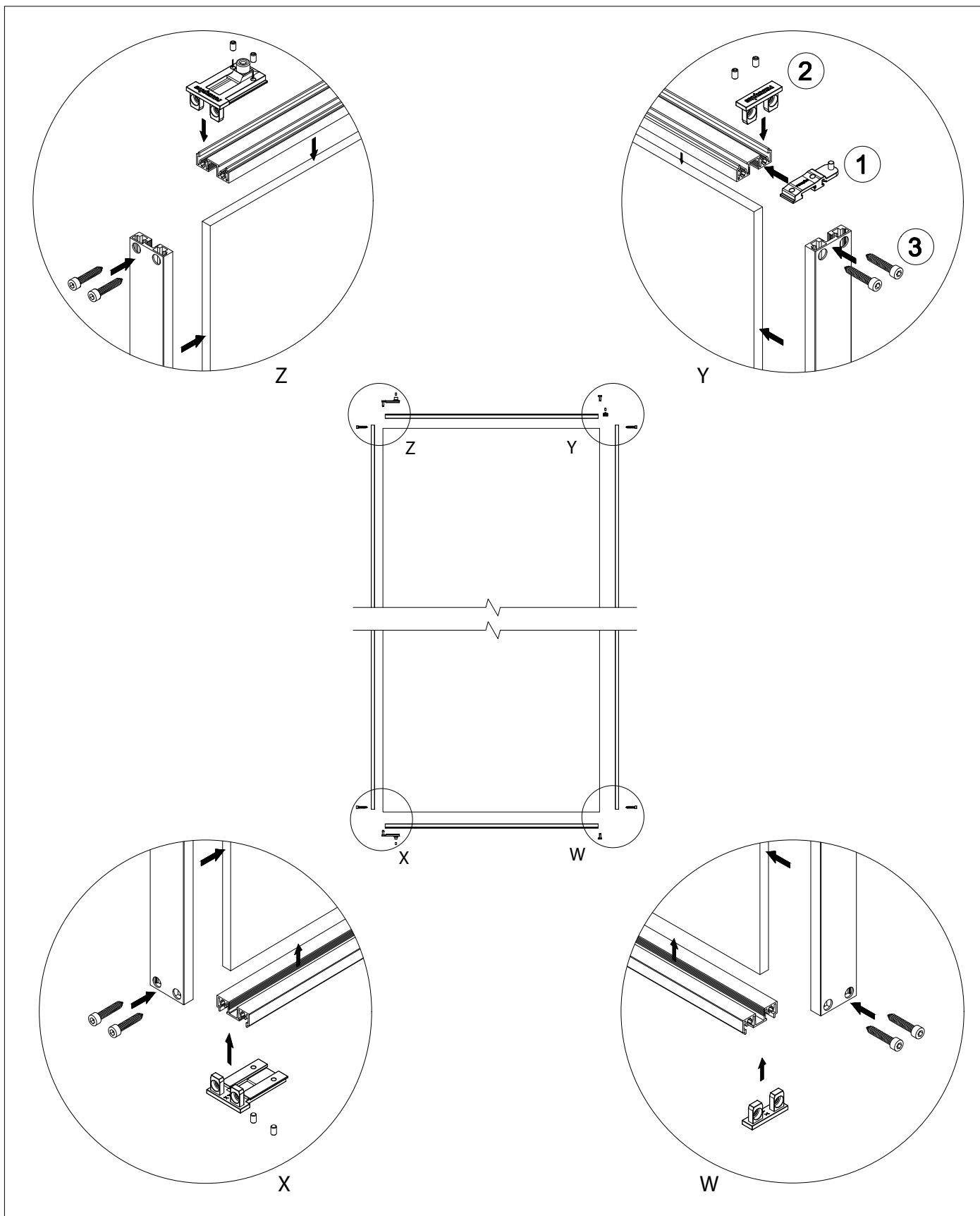

1_

ASSEMBLY INSTRUCTIONS

HINGE DOOR SET S1200 DIN RIGHT

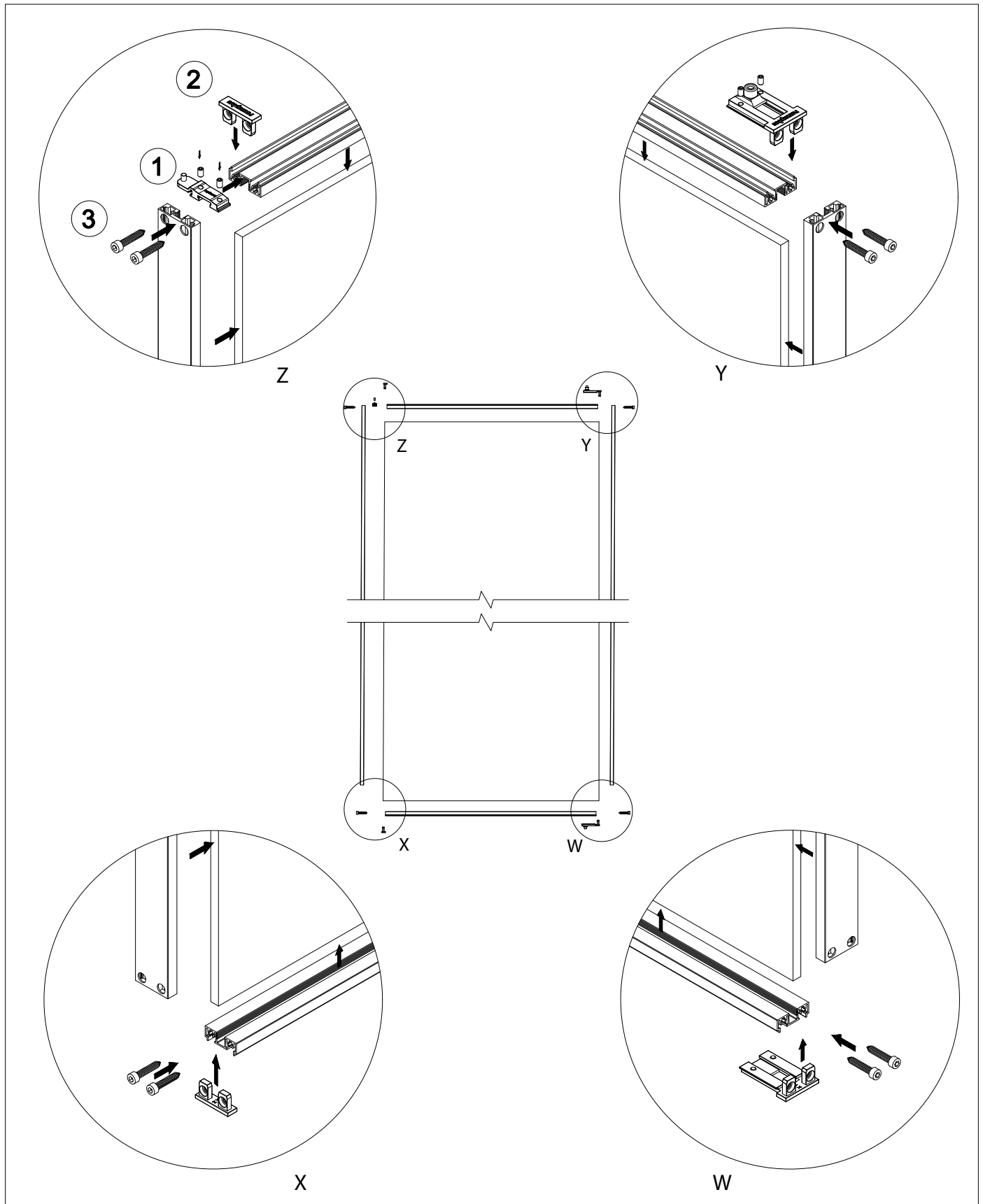

ASSEMBLY INSTRUCTIONS

HINGE DOOR S1200

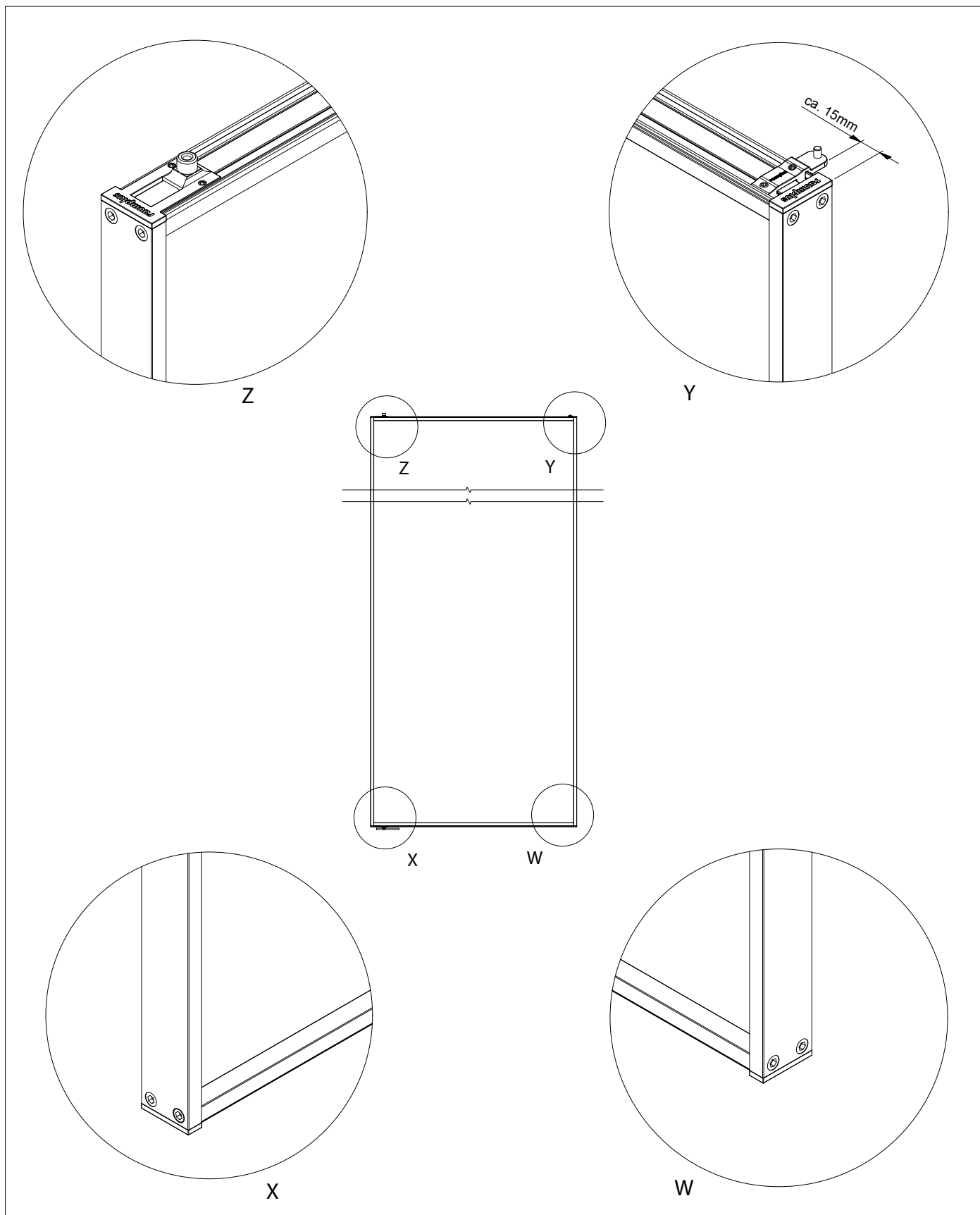

3_ DIN left